

Lohko 130

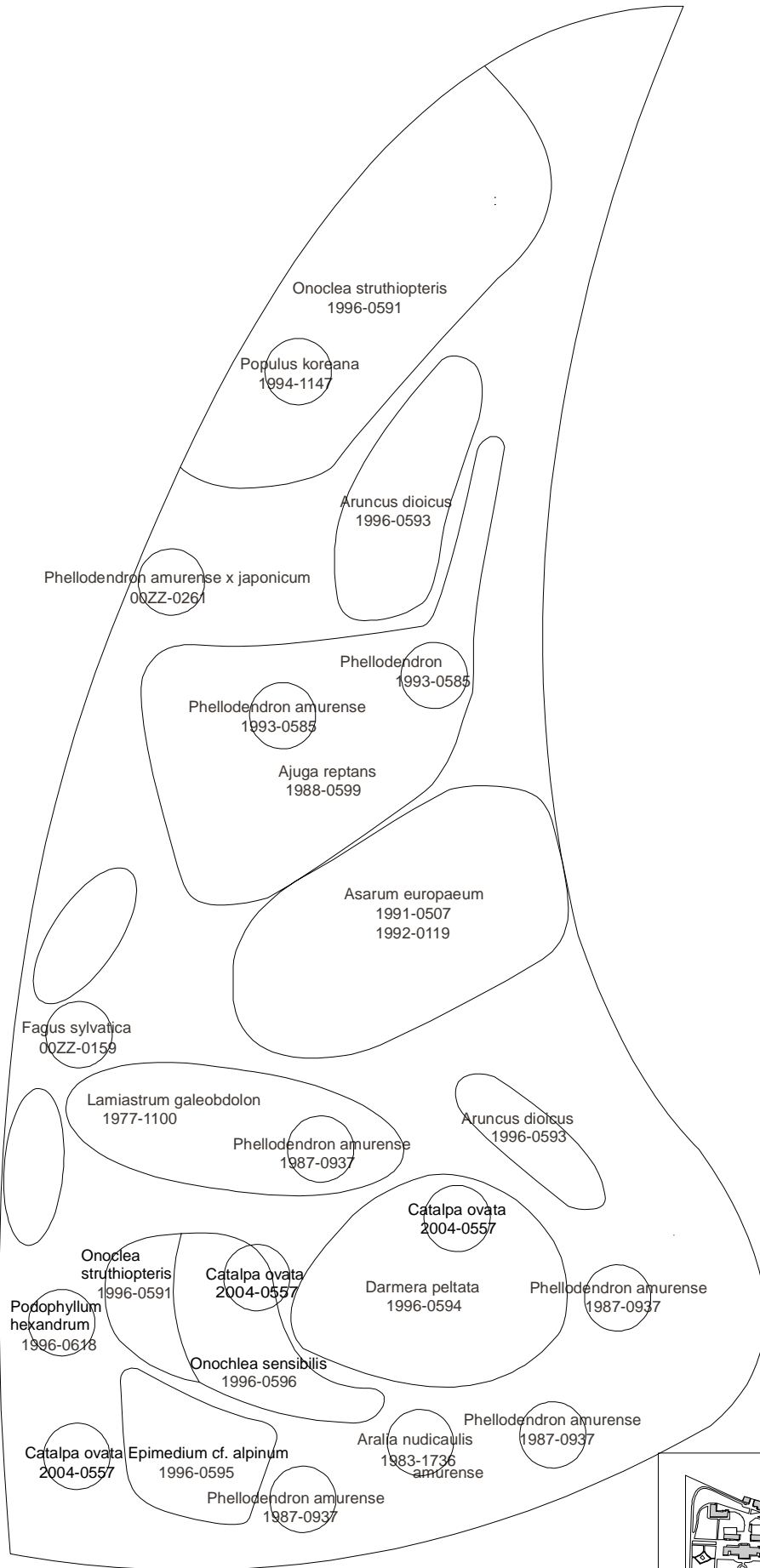

An inset map in the bottom right corner shows a grid of plots, with a small shaded area indicating the location of Lohko 130. To the right of the inset map is a north arrow pointing upwards, labeled with the letter 'N'.

Päivitetty: 07.01.2015 Anneli Vaniala
Inventoitu: 07.09.2012 Henry Väre